



Cymdeithas Deiliad Angorfeydd Marina Pwllheli

Pwllheli Marina Berth Holders Association

Llyr B Jones & Barry Davies
Adran Economi a Chymuned / *Economy and Community Dept*
Cyngor Gwynedd Council
18/10/2014

Cynnwys / Content

Cyflwyniad byr

- **Diweddariad Cynllun Gweithredu Hafan 2012-15**
 - i. Ffioedd Blynyddol
 - ii. Gwaith Carthu
 - iii. Gwasanethau i Gwsmeriaid
 - iv. Buddsoddiadau yn yr Hafan
 - v. Hybu a Marchnata
 - (vi. Cynllun Academi Hwyllo)
- **Cwestiynnau / trafodaeth**

Short Presentation

- ***Update on approved Hafan Action Plan 2012-15***
 - i. Annual Fees*
 - ii. Dredging Works*
 - iii. Services to Customers*
 - iv. Investments in Hafan*
 - v. Marketing and Promotion*
 - (vi. Sailing Academy Project)*
- ***Questions / discussion***

i. Ffioedd Blynyddol

i. Annual Fees

Yn weithredol ers 2012

- Dim cynydd (na chwyddiant) yn ystod y dair blynedd diwethaf
 - 2012/13
 - 2013/14
 - 2014/15

Ar waith / i'r dyfodol

- Ystyried cyd -destun amgylchiadau economaidd
- Adolygu ffioedd ar gyfer 2015/6 (cynydd yn unol â chwyddiant yn unig)

Implemented since 2012

- *No increase (or inflation) applied for during last 3 year period*
 - 2012/13
 - 2013/14
 - 2014/15

Ongoing / future commitment

- *Consider in context of economic circumstances*
- *Review fees for 2015/6 (likely to limit any increase in line with inflation only)*

ii. Gwaith Carthu (1/2)

ii. Dredging Works (1/2)

Yn weithredol ers 2012

- Mynediad i'r sianel wedi ei garthu yn 2012, 2013 & 2014
- Domen dywod ger ceg yr harbwr wedi ei symud yn 2012
- Polion wedi eu symud o'r sianel yn 2012 i wella mordwyo
- Gwelliannau i'r cynorthwyon mordwyo
- Peth gwaith lefelu wedi ei wneud yn 2011, 2013 & 2014
- Arolygon Hydrograffig - amryw

Implemented since 2012

- *Dredging of harbour entrance carried out in 2012, 2013 & 2014*
- *Removal of stockpile from entrance of channel in 2012*
- *Removal of piles from channel to improve navigation in 2012*
- *Improvements to Navigational Aids*
- *Limited bed-levelling works carried out in 2011, 2013 & 2014*
- *Hydrographic Surveys – various*

ii. Gwaith Carthu (2/2)

ii. Dredging Works (2/2)

Wedi eu gweithredu

- Gwaith carthu sylweddol yn ystod 2014 (yn cynnwys sianel a basin marina)
- Ad-ennill tir er mwyn gwaredu gwaddodion
- Arolwg o'r sianel

Ar waith / ymrwymadau

- Adolygiad Strategaeth Garthu (2014)
- Datrysiaid tymor hir
- Gwelliannau i'r angorfeydd yn y sianel
- Gwelliannau i'r angoreydd

Implemented

- *Major dredging campaign implemented in 2014 (inc channel & marina basin)*
- *Land reclamation to dispose dredged material*
- *Channel survey*

Ongoing / future commitment

- *Dredging Strategy Review (2014)*
- *Long term dredging solution*
- *Channel moorings improvements*
- *Improvements to pontoons*

iii. Gwasanethau i Cwsmeriaid (1/2)

iii. Services to Customers (1/2)

Yn weithredol ers 2012

- Darpariaeth trydan ar gyfer cwsmeriaid blynyddol
- Ffioedd lansio wedi eu lleihau
- Cyfradd is i gwsmeriaid ar gyfer storio ar y lan
- Cynllun Discownt wedi ei beilotio yn 2012/13
- Darpariaeth Direct Debit
- Lleihad cyfradd ymwelwyr
- Holiadur cwsmeriaid
- WIFI am ddim

Implemented since 2012

- *Free electricity ashore for annual customers*
- *Launching fees for vessels discounted*
- *Cheaper rate for storing ashore for annual customers*
- *Early Booking Discount piloted for 2012/13*
- *Introduction of Direct Debit*
- *Visitor overnight rate reduced*
- *Customer survey*
- *Free WIFI*

iii. Gwasanethau i Cwsmeriaid (2/2)

iii. Services to Customers (2/2)

Ar waith / ymrwymiadau

- Ystyried bellach i Holiadur Blynyddol i gwsmeriaid
- Ystyried pecynnau cymhellion i'r dyfodol
 - Tueddiadau'r farchnad / marinas eraill
 - Agored i awgwrymiadau
- Perthynas adeiladol gyda'r Gymdeithas

Ongoing / future commitments

- *Further consideration to annual Customer Questionnaire*
- *Consider future incentive packages*
 - *Market trends / other marinas*
 - *Suggestions welcome*
- Constructive dialogue with PMBHA

iv. Buddsoddiadau yn yr Hafan

iv. Investments in Hafan

Wedi eu gweithredu ers 2012

- Pryniant Hoist newydd yn 2012
- Tractor newydd yn 2012
- Gwelliannau i'r angorfeydd
- Gwelliannau tymor byr i'r cawodydd yn 2013

Ar waith / Ymrwymadau i'r Dyfodol

- Gwelliannau pellach i'r angorfeydd
- Pontwn Tanwydd

Implemented since 2012

- *Purchase of new Hoist in 2012*
- *Purchase of new tractor in 2012*
- *Improvements to pontoons*
- *Short term Improvements to showers during 2013*

Ongoing / Future Commitments

- *Further improvements to pontoons*
- *Fuel Pontoon*

v. Hybu a Marchnata v. Marketing and Promotion

Wedi eu gweithredu ers 2012

- Safle We newydd
- Cynllun Marchnata yn 2013
- 'Pecyn Croeso' i ymwelwyr

Ar waith / ymrwymadau i'r Dyfodol

- Cylchlythyr & Llawlyfr yr Hafan
- Strategaeth Marchnata
- Cyfleoedd yn gysylltiedig gyda cynllun Academi
- Pwysigrwydd negeseuon / canfyddiadau yn cael eu cyfleu o Bwllheli
- Cyfraniad yr Hafan at pecynnau sy'n marchnata'r ardal

Implemented since 2012

- *New Hafan website*
- *Marketing Plan prepared in 2013*
- *Visitors 'Welcome Pack'*

Ongoing / future commitments

- *Hafan Newsletter & Handbook*
- *Marketing Strategy*
- *Marketing opportunities linked with Academy proposal*
- *Importance of messages / perceptions conveyed from Pwllheli*
- *Hafan's contribution in wider marketing initiatives*

vi. Cynllun Academi Hwyllo - Safle vi. Sailing Academy Project - Site

1 site plan

Welsh National Sailing Academy & Events Centre, Pwllheli - Building

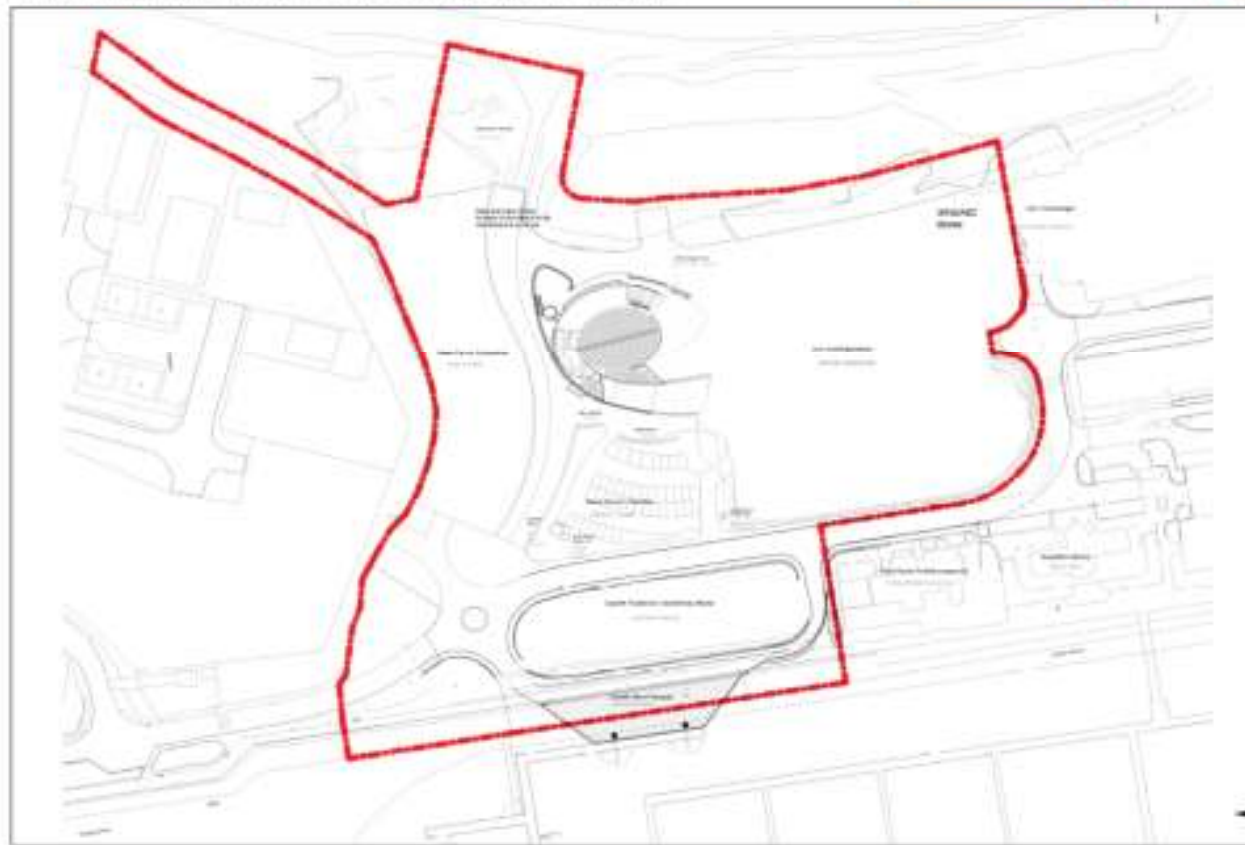

Cynllun Academi Hwyllo – Cynlluniau Llwr Sailing Academy Project – Floor Plans

2 floor plans

Welsh National Sailing Academy & Events Centre, Pwllheli - Building



Cynllun Academi Hwyllo – Cynlluniau Llwr Sailing Academy Project – Floor Plans

3 floor plans

Welsh National Sailing Academy & Events Centre, Pwllheli - Building

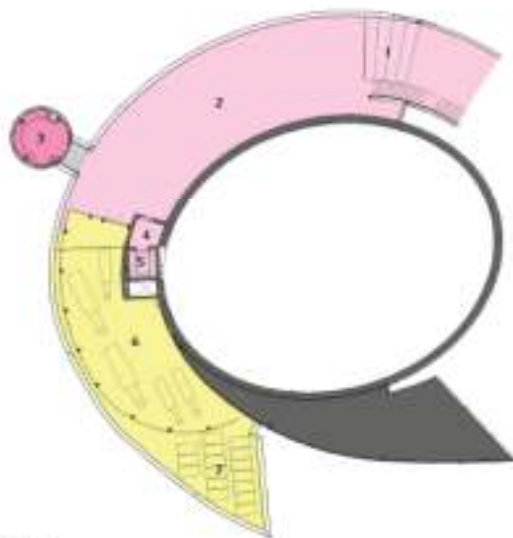

Second Floor Plan

1. Stair 2 & Terrace Seating
2. Roof Terrace
3. Lookout Point
4. Lift Lobby
5. Lift
6. Enclosed mechanical plant
7. PV Panels

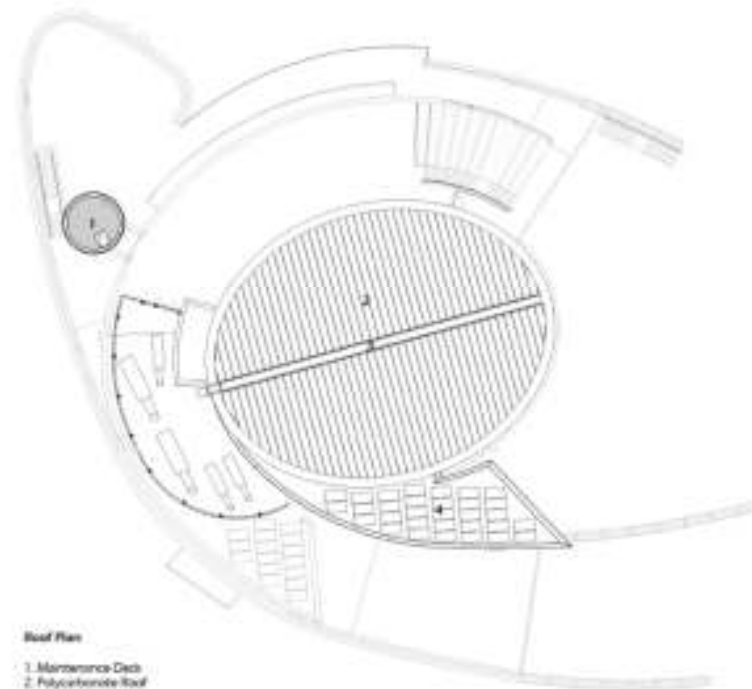

Roof Plan

1. Maintenance Deck
2. Polycarbonate Roof
3. Access Walkway
4. PV Panels

Cynllun Academi Hwyllo – Perspectif Safle Sailing Academy Project –Site Perspective

4 site perspective

Welsh National Sailing Academy & Events Centre, Pwllheli - Building



www.gwynedd.gov.uk



Cynllun Academi Hwyllo – Perspectif Safle Sailing Academy Project –Site Perspective

5 site perspective

Welsh National Sailing Academy & Events Centre, Pwllheli - Building



Cynllun Academi Hwyllo – Perspectif Safle Sailing Academy Project –Site Perspective

6 site perspective

Welsh National Sailing Academy & Events Centre, Pwllheli - Building



Cynllun Academi Hwyllo – Edrychiad Mewnol

Sailing Academy Project – Internal View

7 internal view - plywood

Welsh National Sailing Academy & Events Centre, Pwllheli - Building



Cynllun Academi Hwyllo – Edrychiad Mewnol

Sailing Academy Project – Internal View

10 internal view - plywood

Welsh National Sailing Academy & Events Centre, Pwllheli - Building



I Gloi

To conclude



- Diolch yn fawr
- Cwestiynnau / trafodaeth
- *Thank you*
- *Questions / discussion*